

Arrow guide



Pull



Push



Point



Twist

Preparation

Before you start

Preparation

1

Before following the user steps described in this user guide, please make sure to carefully read the information and disclaimers in the bottom of the last page. Please note that the information provided in this guide is not a substitute for professional medical advice or for reading the instructions for use (IFU) that comes with the infusion set.



Preparation

2

Wash your hands before inserting the infusion set.



Preparation

3

Choose an insertion site as recommended by your healthcare provider. **Do not** use an area right next to your previous infusion site.



Preparation

4

Clean the area for insertion with disinfectant as directed by your healthcare provider. Be sure the area is air dry before inserting the infusion set.

Insertion

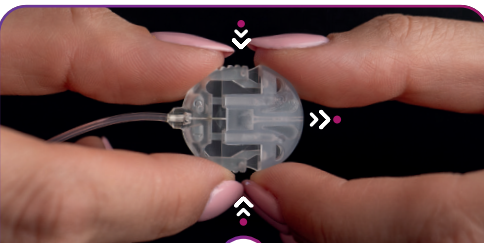

Insertion

5

Take the infusion set out of the sterile packaging. Remove the paper from the tubing and the circular protective cap from the connector needle by gently squeezing the sides of the connector needle and pulling the protective cap off.

Caution

Ensure sterility by checking if the packaging is undamaged. **Do not** use if the infusion set is already open or has been damaged.

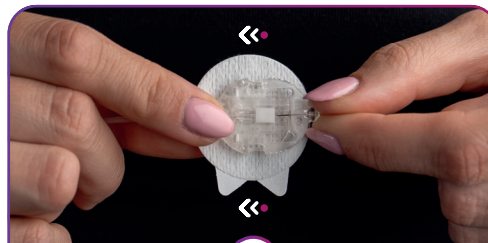

Insertion

6

To connect the connector needle to the coupling housing, hold the connector needle where it connects to the tubing and insert it into the coupling housing until you hear a "click".

Tip

The connector needle can only be inserted one side up. If you feel resistance during insertion, turn the connector needle around to insert with ease.



Insertion

7

Follow your pump manufacturer's instructions for use to connect the infusion set tubing to the pump reservoir and pump.

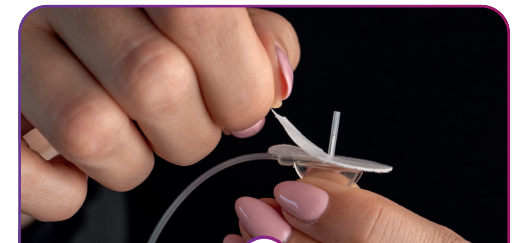

Insertion

8

Grab the retaining wings of the infusion set and carefully remove the backing paper from the adhesive tape. Avoid touching the adhesive tape when removing the backing paper.

Arrow guide



Pull



Push



Point



Twist

Insertion

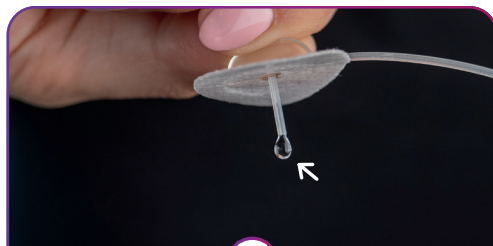

Insertion 9

Hold the infusion set with the needle pointing down. Prime the infusion set according to the pump manufacturer's instructions for use until insulin dispenses from the needle. Ensure there are no air bubbles in the tubing.

Caution
Never fill the tubing while the infusion set is connected to your body.

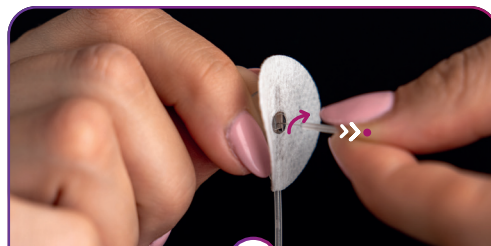

Insertion 10

Remove the needle guard by gently twisting and then carefully pulling it. Avoid touching the adhesive tape when removing the needle guard.

Tip
Do not skip twisting the needle guard before pulling it off as it helps removing it gently.



Insertion 11

Pinch the skin at the insertion site with one hand. With the other hand, insert the infusion set at a 90-degree angle.



Insertion 12

Gently massage the adhesive tape onto the skin.

Insertion



Insertion 13

Remove the paper from the adhesive tape on the coupling housing.



Insertion 14

Attach the coupling housing on your skin somewhere that will allow for easy disconnection. Gently massage the adhesive tape onto the skin.

Tip
Ensure that the short tail of tubing between the needle and the coupling housing is not too tight.

Arrow guide



Disconnecting



Disconnecting

A

This infusion set allows you to temporarily disconnect your pump without having to change the infusion set. Disconnect the connector needle from the coupling housing by gently pressing the sides of the connector and pulling the needle straight out.

Tip

Place your finger in front of the coupling housing when disconnecting to keep the adhesive in place.

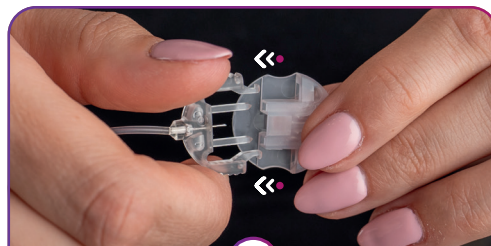

Disconnecting

B

Connect the circular protective cap to the connector needle.



Disconnecting

C

Connect the disconnect cover to the coupling housing.

Arrow guide



Reconnecting

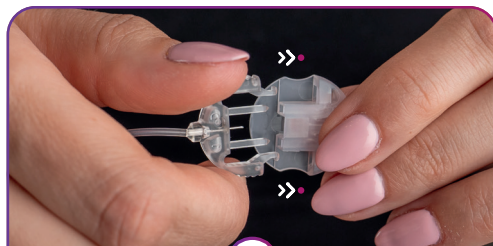

Reconnecting

D

Before reconnecting the infusion set, make sure the adhesive still sits securely on the skin. Remove the circular protective cap from the connector needle.

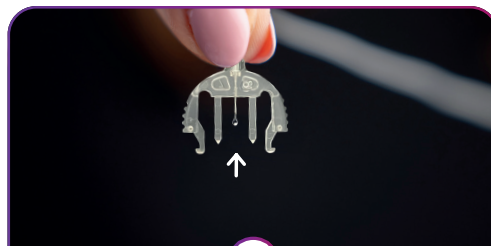

Reconnecting

E

Hold the infusion set with the needle pointing down. Prime the infusion set according to the pump manufacturer's instructions for use until insulin dispenses from the needle. Ensure there are no air bubbles in the tubing.

⚠ Caution

Never fill the tubing while the infusion set is connected to your body.

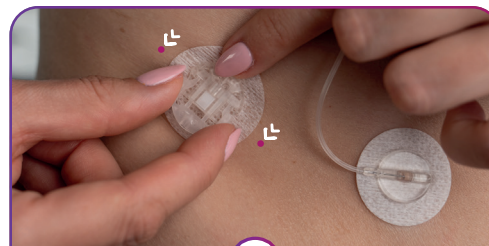

Reconnecting

F

Remove the disconnect cover from the coupling housing.

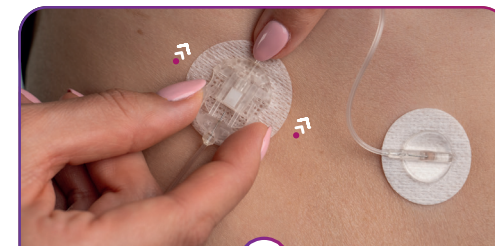

Reconnecting

G

Place a finger in front of the coupling housing and push the connector needle straight in until you hear a "click".

📌 Tip

The connector needle can only be inserted one side up. If you feel resistance during insertion, turn the connector needle around to insert with ease.