



CUT-TO-FIT | PRE-CUT | FLAT | CONVEX

Stoma care **Application Guide**

Convatec Esteem Synergy®
and Esteem Synergy®+
Two-piece Solution



Accessories

Support Products

Accessories - designed for easy daily use with one-piece and two-piece stoma solutions.



Pouch Removal



ESENTA™ Sting Free Adhesive Remover Spray and Wipes

ESENTA™ Sting-free adhesive spray and wipes quickly remove all adhesive residue and help to reduce painful skin stripping and skin damage. For fast and easy adhesive release feeling silky and smooth.



Skin Preparation



ESENTA™ Sting Free Skin Barrier Spray and Wipes

ESENTA™ skin barrier creates a breathable barrier on the skin, reducing the risk of skin damage and irritation caused by body wastes, enzymes, and adhesives. Safe and effective even with frequent use.



Added Security



Diamonds™ Gelling and Odour Control Sachets

Super absorbent gelling sachets with unique ActiveOne™ odour control. Prevents leaks, odour and noise. Provides a flatter, discreet pouch.

To order call UK **0800 282 254** ROI **1800 721 721**

Esteem Synergy® & Esteem Synergy®+

APPLICATION GUIDE

CHOOSE BASEPLATE

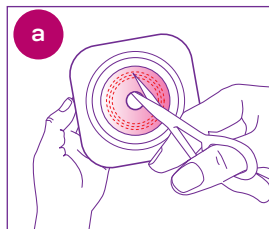

a. Cut-To-Fit Trace the shape of the stoma on to the baseplate using your stoma cutting guide. Cut the baseplate just outside the tracing, taking care not to cut the pouch film. Smooth cut opening with finger.

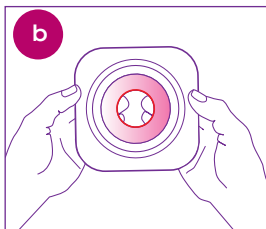

b. Pre-Cut Select pouch with pre-cut hole slightly larger than your stoma.

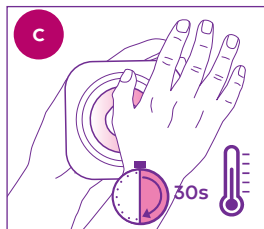

c. Mouldable Warm the mouldable baseplate between your hands for 30 seconds. Roll and shape the Mouldable Technology™ to the size and shape of your stoma. **Do not stretch, pull or cut.**

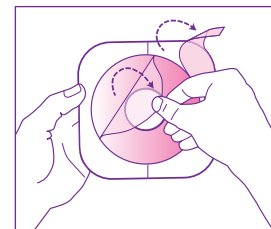
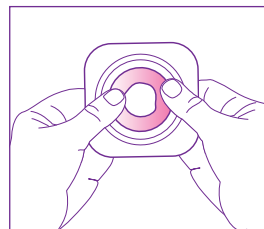

Remove release liner.

APPLYING THE POUCH

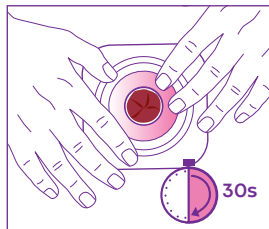

Press the baseplate into place. Smooth and hold the baseplate in place for 30 seconds.

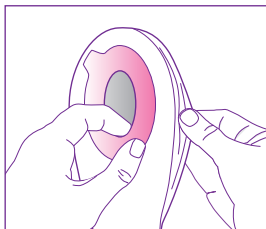

Separate pouch films to allow air to enter.

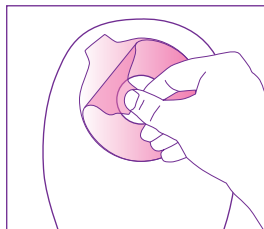

Remove the release liner from the adhesive foam ring on the pouch.

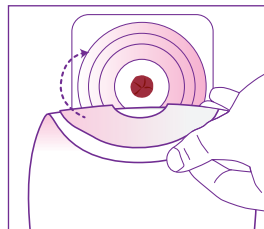

Soft fold the adhesive foam ring on the pouch. Apply the lower half of the pouch to the baseplate 'landing zone'. Roll or slide your fingers over the upper half to secure the pouch.

CLOSING YOUR DRAINABLE POUCH

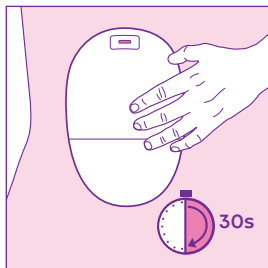

Smooth and hold in place for 30 seconds. **Always double check the coupling is completely attached, if not repeat the steps.**

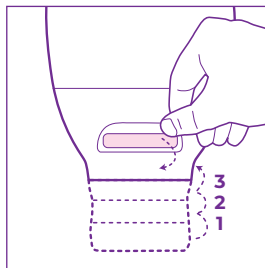

Invisiclose® Closure Fold tail closure with outlet strip until interlocking closures overlap. Press interlocking closures together across the width of the tail and squeeze until you feel them close. **Lock-it Pocket™** Turn pocket inside-out to conceal the tail closure.

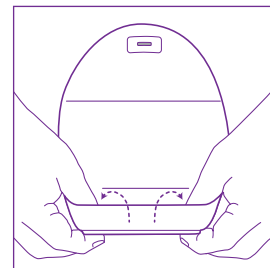
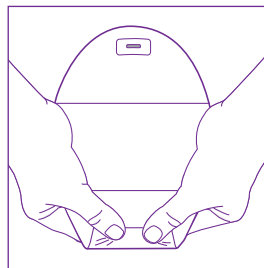

EMPTYING YOUR DRAINABLE POUCH

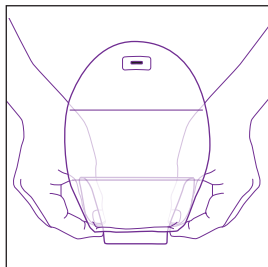

Invisiclose® Closure Take out the tail from Lock-it Pocket™. Unfold pouch closure and open the tail by squeezing in the outlet strips; drain pouch.

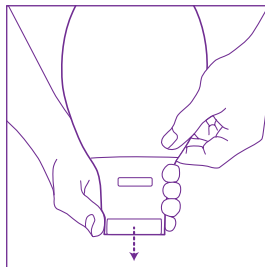
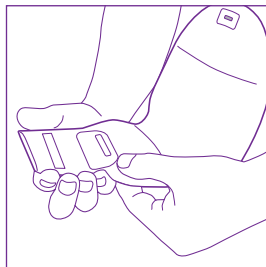

FILTER

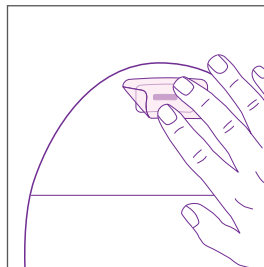

Filter Cover the filter with a filter sticker for any water activity and remove after activity.

UROSTOMY POUCH – OPEN, CLOSE AND CONNECTING TO NIGHT BAG

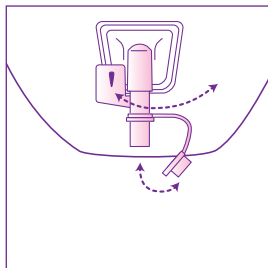

Accuseal™ Tap
Open and close

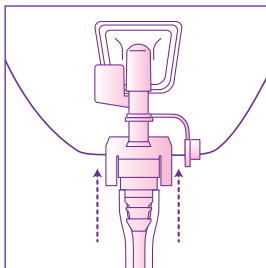

Connect Accuseal™
connector

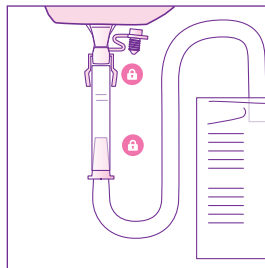

Connecting your night bag Once your pouch tap is open, attach the connector to the tap and your night bag to the connector. Check all connection points are secure.

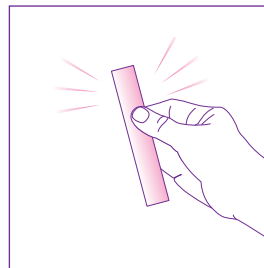

Retain your connector
each time you dispose of
your night bag.

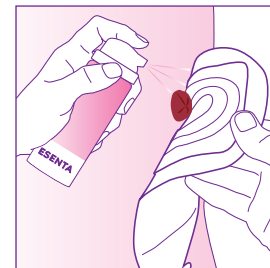

For gentle removal use
Niltac™ wipe or spray
around edge of the
baseplate and wait a few
seconds. Gently peel
baseplate away from skin.

For more information call UK **0800 282 254** ROI **1800 721 721**

Helpful numbers

To speak to one of our Product Specialists

Call UK **0800 282 254** - ROI **1800 721 721**

To speak to one of our me+™ Advisors

Call UK **0800 467 866** - ROI **1800 721 721**

To speak to our Clinical Nurse Specialist

Call UK **0800 085 2516** - ROI **1800 721 721**

To speak to one of our Amcare™ Agents*

Call **0800 88 50 50**



* Not available in Ireland. 1 - Reference: 1. Voegeli D, LBF® "No-Sting" Barrier Wipes: Skin Care Using Advanced Silicone Technology. British Journal of Nursing, 2008; Vol. 17: No. 7.
©2024 Convatec®/™ all the trademarks are the property of Convatec group companies. AP-030468-MRL-GB OST340



Printed on FSC mix recycled paper. FSC forests are managed with consideration for people, wildlife and the environment.